



12 Ashfield Road, Thornton, Bradford, BD13 3PN

£380,000

- IMPOSING PERIOD SEMI DETACHED
- TWO LARGE RECEPTION ROOMS
- UNRIVALLED FLOOR SPACE
- SET OVER THREE FLOORS
- GAS CH / UPVC DG / ALARM SYSTEM
- SIX BEDROOMS & TWO BATHROOMS
- PACKED WITH CHARACTER FEATURES
- DRIVEWAY AND ENCLOSED REAR GARDEN
- LARGE BASEMENT OFFERING POTENTIAL
- ELECTRIC CAR CHARGE POINT

12 Ashfield Road, Bradford BD13 3PN

**** IMPOSING SIX BEDROOM PERIOD SEMI DETACHED ** PACKED WITH CHARACTER FEATURES ** WELL PRESENTED THROUGHOUT ** SET OVER THREE FLOORS PLUS LARGE CELLAR ** RARE TO THE MARKET **** Bronte Estates are delighted to list for sale this substantial and most impressive family home, located in the heart of Thornton with village amenities including schools, bus routes and country walks just a minutes walk away. This extremely spacious property really has to be seen internally to be fully appreciated and briefly comprises of; Entrance Hall, Living Room, Kitchen, Conservatory, large Cellars offering further potential, three first floor Bedrooms and the family Bathroom, plus a further three Bedrooms, Shower Room and walk-in storage room to the second floor. Enclosed, mature garden to the rear and a driveway to the side with parking for up to three cars & EV charge point. A very special property indeed. Register your interest with us without delay.



Council Tax Band: C



Ground Floor

Entrance Hall

19'2 x 5'8

A very grand entrance hall with a stunning tiled floor, original staircase and balustrade, plus ornate plasterwork. Central heating radiator and doors off to the living room, dining room and cellars.

Living Room

14'9 x 13'7

An impressive reception room, filled with natural light from the large bay window to the front and a further side window. Rustic style fireplace with an inset living flame gas fire, polished wood flooring, four wall lights, picture rail, ceiling rose and a central heating radiator.

Dining Room

15'8 x 14'8

Another spacious reception room with a superb polished wood floor and windows to two elevations. Feature cast iron gas stove, picture rail and two central heating radiators. Open to the kitchen and conservatory.

Kitchen

10'5 x 5'10

Fitted with a range of base and wall units, laminate work surfaces and complimentary splash-back wall tiling. Integrated fridge, double Bosch oven and grill and a Smeg five ring gas hob with extractor above. Stainless steel sink & drainer and a window to the rear elevation.

Conservatory

9'3 x 8'5

UPVC windows and a door to the rear garden. Stone floor and a central heating radiator.

Lower Ground Floor

Large basement cellar rooms. Measurements TBC.

First Floor

Landing area with open spindle balustrade leading off to the second floor and doors to three bedrooms and the family bathroom.

Bedroom One

15'8 x 12'2

Fitted with a range of wardrobes and cupboards providing a good amount of storage. Window to the rear elevation, feature fireplace, picture rail and a central heating radiator.

Bedroom Two

13'9 x 13'5

Window to the front elevation, picture rail, period style fireplace and a central heating radiator.

Bedroom Three

10'2 x 7'2

Currently used as a craft / hobbies room. Window to the front elevation and a central heating radiator.

Bathroom

10'3 x 7'4

A modern and spacious 'wet room' family bathroom comprising of a large walk-in shower enclosure with glass screen and an electric shower, pedestal washbasin and a low-suite WC. Stained glass window, fully tiled walls and a chrome heated towel rail.

Second Floor

A spacious landing area with velux roof window and access to the loft space.

Bedroom Four

13'9 x 10'9

Velux roof window with integrated roller blind, exposed beams and a central heating radiator.

Bedroom Five

13'9 x 10'7

Velux roof window with integrated roller blind, fitted storage cupboard, exposed beams and a central heating radiator. Currently used as a music room.

Bedroom Six

14'9 x 7'7

Window to the side elevation with stunning long range views and a central heating radiator. Currently used as a home office.

Storage Room

8'8 x 7'3

A useful and very generous storage space just off the second floor landing, providing a considerable amount of storage.

Shower Room

Shower cubicle with electric shower, pedestal washbasin, low-suite WC and a heated towel rail.

External

To the front of the property is an enclosed, patio garden area with stone wall boundary and garden gate. To the side of the property is a private driveway with parking for up to three cars and a stone wall with gate leading to the rear. The rear garden consists of paved patio seating areas, lawns, stone pathways, flowerbeds and a range of mature shrubs & trees.

Please Note

The current owner advises that the roof was replaced approx. eight years ago, including work to the chimneys. The central heating boiler is also still under guarantee.



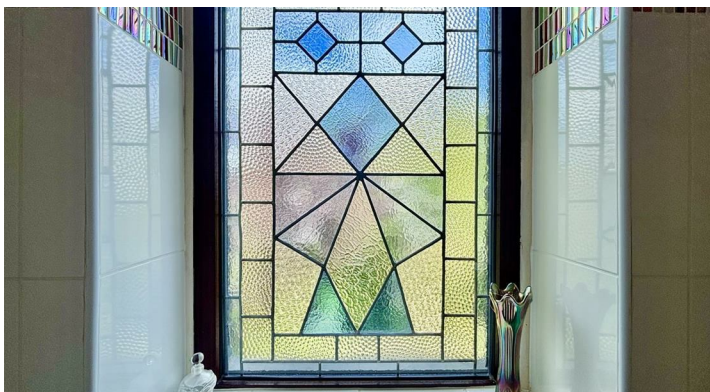

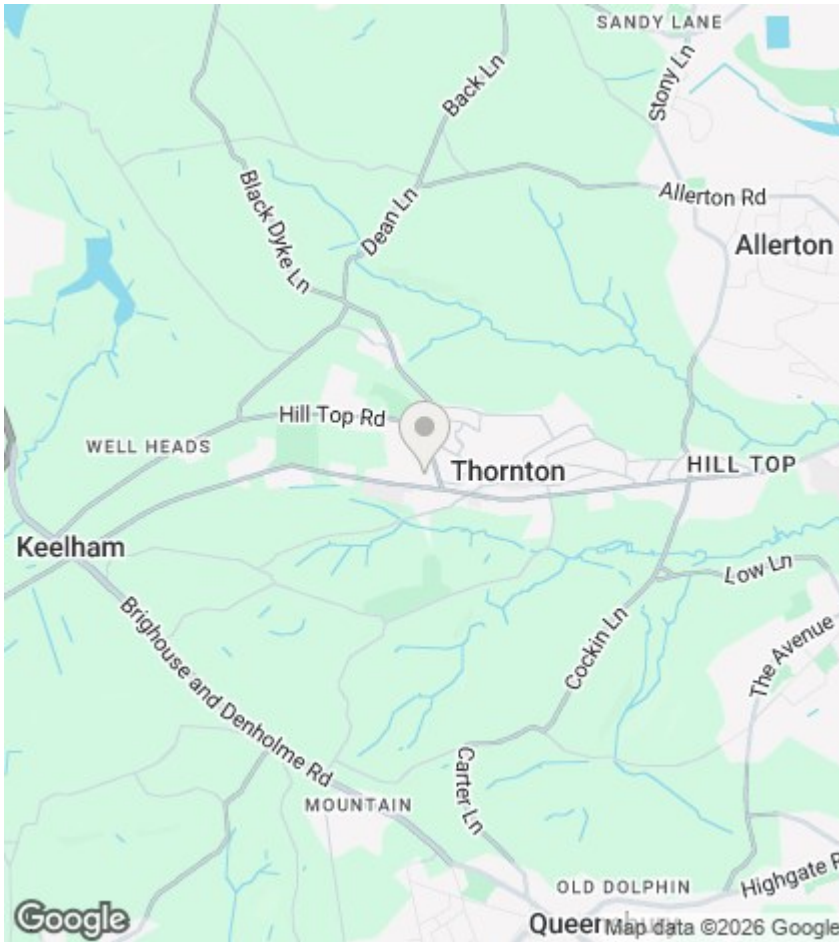

Directions

Viewings

Viewings by arrangement only.
Call 01274884040 to make an appointment.

EPC Rating:

D

Energy Efficiency Rating		Current	Potential
Very energy efficient - lower running costs			
(92 plus) A			
(81-91) B			
(69-80) C			80
(55-68) D		60	
(39-54) E			
(21-38) F			
(1-20) G			
Not energy efficient - higher running costs			
England & Wales		EU Directive 2002/91/EC	

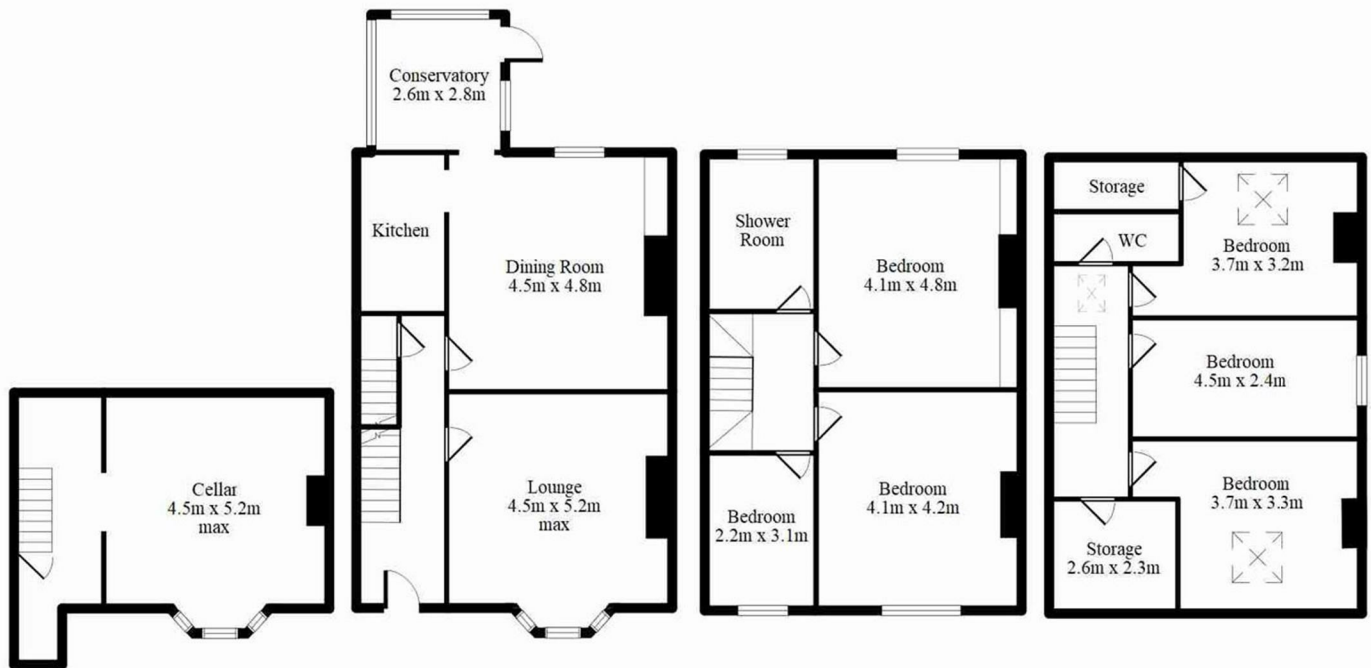

Every attempt has been made to ensure this floor plan is accurate, however their accuracy is not guaranteed. The floorplan is for illustrative purposes and should be used in that context. GFPMIS 2026